

Property Owner Questionnaire



Edgewater Landscaping
2957 Cty Rd. CX P.O. Box 757
Portage, WI 53901
608-742-6558
www.edgewaterhomeandgarden.com

Your Appointment has been scheduled for: Time: _____ Date: _____

Appointment Type: _____

Client name: _____

Mailing address: **Street** _____ **City/Town:** _____

Zip: _____

Phone numbers: _____

E-mail: _____

Location type: _____

Check off the items you have for the first meeting.

Copies of the following for Edgewater to keep for reference:

YES NO

- | | | |
|--------------------------|--------------------------|--|
| <input type="checkbox"/> | <input type="checkbox"/> | Property Photos |
| <input type="checkbox"/> | <input type="checkbox"/> | House Plans |
| <input type="checkbox"/> | <input type="checkbox"/> | Site plan for construction |
| <input type="checkbox"/> | <input type="checkbox"/> | Septic system plan |
| <input type="checkbox"/> | <input type="checkbox"/> | Wetland, flood plain or ordinary high water mark plan |
| <input type="checkbox"/> | <input type="checkbox"/> | Certified Survey |
| <input type="checkbox"/> | <input type="checkbox"/> | Covenants |
| <input type="checkbox"/> | <input type="checkbox"/> | Existing permits, compliance orders and/or enforcement actions (fines) |
| <input type="checkbox"/> | <input type="checkbox"/> | Previous Landscape plans |

Where did you hear about Edgewater Landscaping? _____

Have you visited our website? _____

Where did you get our number or did you find us in the store? _____



Project and Priorities

Overall Project scope:

Full Scale CAD Drawing

Project Goal:

What are the most important area in your landscape to resolve/fix/develop?

FIRST

SECOND

THIRD

FOURTH

We will not accept this plant, material or feature in our project:

We must have these plant, materials or features in our project:

We have a special event coming up that we would like this project done by.

YES NO

Desired completion date:

Type of event:

Date of event:



We understand that all designs remain the property of Edgewater Landscaping unless released to the client

Initials: _____

Budget Amount/Yr	Installation Year		
	1st	2nd	3rd
\$1,000-\$3,000	<input type="checkbox"/>	<input type="checkbox"/>	<input type="checkbox"/>
\$5,000	<input type="checkbox"/>	<input type="checkbox"/>	<input type="checkbox"/>
\$10,000	<input type="checkbox"/>	<input type="checkbox"/>	<input type="checkbox"/>
\$15,000	<input type="checkbox"/>	<input type="checkbox"/>	<input type="checkbox"/>
\$20,000	<input type="checkbox"/>	<input type="checkbox"/>	<input type="checkbox"/>
\$30,000	<input type="checkbox"/>	<input type="checkbox"/>	<input type="checkbox"/>
\$40,000	<input type="checkbox"/>	<input type="checkbox"/>	<input type="checkbox"/>
\$50,000 or more	<input type="checkbox"/>	<input type="checkbox"/>	<input type="checkbox"/>

What you indicate on the chart should be what you want to spend. The project can be broken up into phases, and done year by year.

We want to be able to give you a final result that reaches your expectations but is within your financial means. Budget planning will help us determine which material types and design considerations to use to meet the monetary allowances.

We want to make your budget work for you!

*** DIY projects that can not be done with on-site sketches and require a CAD drawing will be taken only under special circumstances.



All landscapes require a certain level of maintenance. This may include cutting the grass, trimming the shrubs, weeding, deadheading and fertilizing the plant material. We will provide you with a plant care package that outlines the care needed for each plant as well as a photo and description of the plant to guide you in caring for your new landscape. How a property owner will care for the property can influence how it is designed. Please estimate the amount of time and money you have in your annual budget to address these maintenance concerns.

We plan on having our landscape maintenance done by (Check all that apply):

- Professional Lawn Service
- Handyman
- Ourselves (Maintenance hours per week)
 - 2 hours 8 hours 14 hours
 - 4 hours 10 hours 16 hours
 - 6 hours 12 hours
- We would like to plan on Edgewater helping us perform annual tasks like refreshing the mulch, pruning shrubs, and spring and fall clean ups. Our budget for such tasks is:
 - \$100.00 – \$500.00
 - \$500.00 – \$1,000.00
 - Over \$1,000
- We currently have or will be installing a pond and we are interested in having Edgewater do the spring clean outs and fall shutdowns.

The following destructive animals will possibly visit our property and have an impact on the landscape:

- Deer
- Rabbits
- Mice/voles
- Moles
- Ground hogs
- Beavers
- Skunks
- Opossum
- Dogs
- Farm animals
- Muskrats
- _____



THE EMPHASIS OF OUR PROJECT IS:

YES NO

- Total renovation
- New property landscaping
- Adding to existing landscape
- Commercial Landscaping

OUR DESIGN SHOULD INCLUDE:

YES NO

- Only what our budget will allow (see budget and finance)
- All areas of interest

OUR LEVEL OF OUTDOOR ENJOYMENT IS:

YES NO

- We never see our outside property
- We prefer to enjoy outdoor views from inside our property
- We are outdoors as long as the weather is nice and the insects are not bothering us
- We are outdoors no matter what the weather

OUR STYLE IS AS FOLLOWS:

YES NO

- We would like our landscape to blend in with the adjoining properties
- We are looking for a unique landscape that is complimented by its surroundings
- We want a landscape that stands out from the rest and defines our property as outstanding
- We like our plants to be neatly sheared in formal shapes in an orderly fashion
- We like it when plant grow together and their colors and textures blend
- We prefer our plants to have adequate spacing but still have an informal feel
- We prefer spacing where the plants don't touch at all
- We enjoy a combination of both formal and informal plantings

OUR PLANT AND MATERIAL PREFERENCES:

YES NO

- We like to see a combination of leafy and evergreen plants
- We want deciduous (leaf loosing) plant on our property
- We want all evergreen plants in our landscape
- We would like to see perennials in the landscape _____
- We would like to see a specimen plant or sculpture piece as a focal point in our landscape _____
- We would like to see native or prairie plants in our landscape
- We prefer bark/mulch between our plantings Color: _____
- We prefer a stone mulch Type: _____
- We are interested in Unilock products _____
- We are interested in natural stone materials or other materials from the area _____
- We like the look of some exotic materials and would like them in our landscape (materials not from the area _____)
- We prefer man-made materials (plastics, metals composites, etc.) _____
- We would like to use environmentally sound products whenever possible _____



WE ARE INTERESTED IN THE FOLLOWING LANDSCAPE TYPES:

- | | | | |
|--------------------------|---|--------------------------|--|
| YES | NO | YES | NO |
| <input type="checkbox"/> | <input type="checkbox"/> Traditional Landscaping | <input type="checkbox"/> | <input type="checkbox"/> Japanese Gardens |
| <input type="checkbox"/> | <input type="checkbox"/> Ponds and Water Gardens | <input type="checkbox"/> | <input type="checkbox"/> English Country Gardens |
| <input type="checkbox"/> | <input type="checkbox"/> Prairie or Native Plantings | <input type="checkbox"/> | <input type="checkbox"/> American Gardens |
| <input type="checkbox"/> | <input type="checkbox"/> Hardscaping projects – patios/
walkways | <input type="checkbox"/> | <input type="checkbox"/> Rock Gardens |

WE ARE INTERESTED IN HIGHLIGHTING THE FOLLOWING ON OUR PROPERTY:

- | | | | |
|--------------------------|---|--------------------------|---|
| YES | NO | YES | NO |
| <input type="checkbox"/> | <input type="checkbox"/> Butterflies | <input type="checkbox"/> | <input type="checkbox"/> Rock or Japanese Gardens |
| <input type="checkbox"/> | <input type="checkbox"/> Hummingbirds | <input type="checkbox"/> | <input type="checkbox"/> Herbs |
| <input type="checkbox"/> | <input type="checkbox"/> Songbirds | <input type="checkbox"/> | <input type="checkbox"/> Fruits |
| <input type="checkbox"/> | <input type="checkbox"/> Moonlight Gardens | <input type="checkbox"/> | <input type="checkbox"/> Woodland Plants |
| <input type="checkbox"/> | <input type="checkbox"/> Cut Flowers | <input type="checkbox"/> | <input type="checkbox"/> Prairie Plants |
| <input type="checkbox"/> | <input type="checkbox"/> Fragrances | <input type="checkbox"/> | <input type="checkbox"/> Native Plants |
| <input type="checkbox"/> | <input type="checkbox"/> Water Garden, Pond or Fountain | <input type="checkbox"/> | <input type="checkbox"/> Container Gardening |
| <input type="checkbox"/> | <input type="checkbox"/> Lighting | <input type="checkbox"/> | <input type="checkbox"/> Annuals |

WE ENJOY THE FOLLOWING COLORS:

- | | | | |
|--------------------------|-----------------------------------|--------------------------|---------------------------------|
| YES | NO | YES | NO |
| <input type="checkbox"/> | <input type="checkbox"/> Red | <input type="checkbox"/> | <input type="checkbox"/> Orange |
| <input type="checkbox"/> | <input type="checkbox"/> Burgundy | <input type="checkbox"/> | <input type="checkbox"/> Yellow |
| <input type="checkbox"/> | <input type="checkbox"/> Pink | <input type="checkbox"/> | <input type="checkbox"/> Brown |
| <input type="checkbox"/> | <input type="checkbox"/> Fuschia | <input type="checkbox"/> | <input type="checkbox"/> Cream |
| <input type="checkbox"/> | <input type="checkbox"/> Purple | <input type="checkbox"/> | <input type="checkbox"/> White |
| <input type="checkbox"/> | <input type="checkbox"/> Green | <input type="checkbox"/> | <input type="checkbox"/> Gray |
| <input type="checkbox"/> | <input type="checkbox"/> Blue | <input type="checkbox"/> | <input type="checkbox"/> Black |

THE FOLLOWING ACTIVITIES OCCUR ON OUR PROPERTY:

- | | | | |
|--------------------------|--|--------------------------|---|
| YES | NO | YES | NO |
| <input type="checkbox"/> | <input type="checkbox"/> Ball tossing | <input type="checkbox"/> | <input type="checkbox"/> Dog run |
| <input type="checkbox"/> | <input type="checkbox"/> Sports like soccer, football etc. | <input type="checkbox"/> | <input type="checkbox"/> Horseback riding |
| <input type="checkbox"/> | <input type="checkbox"/> Net or court like volleyball/basketball | <input type="checkbox"/> | <input type="checkbox"/> Reading/sunbathing or other outdoor leisure activities |
| <input type="checkbox"/> | <input type="checkbox"/> Yard Games like croquet or Bocce | <input type="checkbox"/> | <input type="checkbox"/> Clothline |
| <input type="checkbox"/> | <input type="checkbox"/> Woodworking | <input type="checkbox"/> | <input type="checkbox"/> Swing set |
| <input type="checkbox"/> | <input type="checkbox"/> Working on Vehicles | <input type="checkbox"/> | <input type="checkbox"/> Child's swimming pool |
| <input type="checkbox"/> | <input type="checkbox"/> Picnics or Barbecues | <input type="checkbox"/> | <input type="checkbox"/> Club House |
| <input type="checkbox"/> | <input type="checkbox"/> Camp or Cooking fires | <input type="checkbox"/> | <input type="checkbox"/> Beach |
| <input type="checkbox"/> | <input type="checkbox"/> Debris or leaf Burning | <input type="checkbox"/> | <input type="checkbox"/> Dock |
| <input type="checkbox"/> | <input type="checkbox"/> Outdoor activities like hiking | <input type="checkbox"/> | <input type="checkbox"/> Swimming or Boating |

OTHER CONSIDERATIONS:

- | | |
|--------------------------|--|
| YES | NO |
| <input type="checkbox"/> | <input type="checkbox"/> We are interesting in have light designed into our plan |
| <input type="checkbox"/> | <input type="checkbox"/> We own statuary that needs to be placed in our plan _____ |
| <input type="checkbox"/> | <input type="checkbox"/> We are interested in having the following designed into our plan |
| | <input type="checkbox"/> Patio <input type="checkbox"/> Walkway <input type="checkbox"/> Fire pit/place <input type="checkbox"/> Outdoor kitchen <input type="checkbox"/> Gazebo |
| | <input type="checkbox"/> Pergola <input type="checkbox"/> Trellis <input type="checkbox"/> Arbor <input type="checkbox"/> Fountain or pond <input type="checkbox"/> Other, please list |



Edgewater landscaping will be contacting the Diggers Hotline to have the public utilities on your property marked. This includes electric, gas, telephone, TV, cable, water and sewer lines. This will not include any propane lines, electric running from your house (to like a garage), outdoor lighting, invisible fence, and irrigation lines. The property owner is responsible for notifying the workers of the location of these lines.

THE FOLLOWING INFORMATION IS REQUIRED FOR A DIGGERS TICKET:

Please print clearly

Name: _____

County: _____

City Village Township _____

Street address: _____

Side of the street property is located: North South East West

Nearest Intersecting Street: _____

Distance and Direction of property from intersecting street: _____ Feet/Miles
 north east
 south west
Circle one

Map of Building Location (please add driveway and nearest intersecting streets)

Please note the following:

North is at the top of the box
This diagram does not need to be to scale

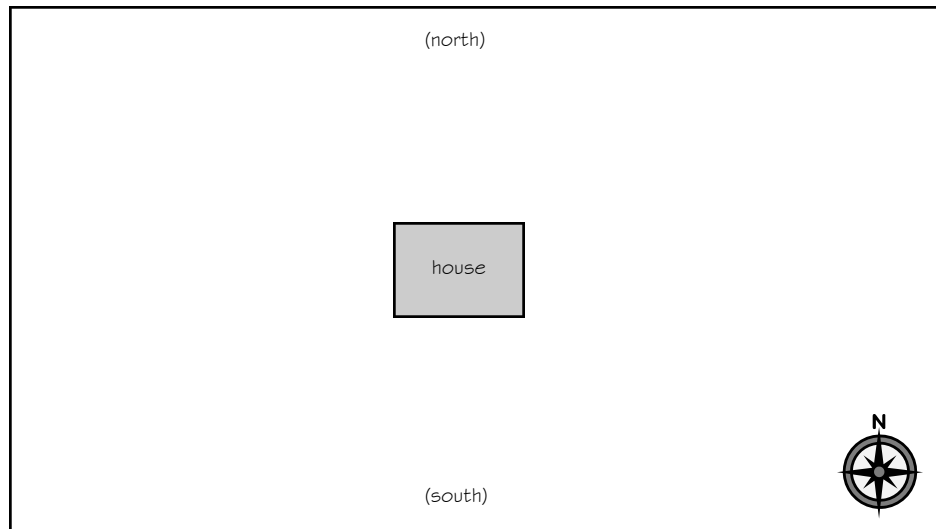

Marking Instructions (for office use only)

Ticket # _____

Marking instructions: _____

Start Date _____



Employees on the job must be aware of the following conditions located on the property

Utility Hazards:

- | YES | NO |
|--------------------------|--|
| <input type="checkbox"/> | <input type="checkbox"/> Septic tanks or system |
| <input type="checkbox"/> | <input type="checkbox"/> Unmarked propane lines |
| <input type="checkbox"/> | <input type="checkbox"/> Unmarked utilities: wires, pipes, cable |
| <input type="checkbox"/> | <input type="checkbox"/> Low overhead wires |
| <input type="checkbox"/> | <input type="checkbox"/> Poorly identified property lines |
| <input type="checkbox"/> | <input type="checkbox"/> Buried fuel tanks |
| <input type="checkbox"/> | <input type="checkbox"/> Abandoned well |

Topographic Hazards:

- | YES | NO |
|--------------------------|--|
| <input type="checkbox"/> | <input type="checkbox"/> Steep Slopes |
| <input type="checkbox"/> | <input type="checkbox"/> Hidden dips and holes |
| <input type="checkbox"/> | <input type="checkbox"/> Uneven terrain |
| <input type="checkbox"/> | <input type="checkbox"/> Falling rocks |
| <input type="checkbox"/> | <input type="checkbox"/> Wetland areas |
| <input type="checkbox"/> | <input type="checkbox"/> Standing water |
| <input type="checkbox"/> | <input type="checkbox"/> Lake or stream |

Animal & Insect Hazards:

- | YES | NO |
|--------------------------|--|
| <input type="checkbox"/> | <input type="checkbox"/> Wasp or wasp nest present |
| <input type="checkbox"/> | <input type="checkbox"/> Loose pets |
| <input type="checkbox"/> | <input type="checkbox"/> Pet debris |
| <input type="checkbox"/> | <input type="checkbox"/> Barbed wire fencing |
| <input type="checkbox"/> | <input type="checkbox"/> Bees or nests in the area |
| <input type="checkbox"/> | <input type="checkbox"/> Other: |

Vegetative Hazards:

- | YES | NO |
|--------------------------|--|
| <input type="checkbox"/> | <input type="checkbox"/> Poison Ivy |
| <input type="checkbox"/> | <input type="checkbox"/> Low branches |
| <input type="checkbox"/> | <input type="checkbox"/> Shrubs and trees with thorns |
| <input type="checkbox"/> | <input type="checkbox"/> Slippery underfoot leaves, etc. |
| <input type="checkbox"/> | <input type="checkbox"/> Obstacles (fallen trees etc.) |
| <input type="checkbox"/> | <input type="checkbox"/> Hazardous Trees |

Exposure Hazards:

- | YES | NO |
|--------------------------|--|
| <input type="checkbox"/> | <input type="checkbox"/> Severe heat – radiates off building |
| <input type="checkbox"/> | <input type="checkbox"/> Severe wind – tunneling effect |
| <input type="checkbox"/> | <input type="checkbox"/> High waves |
| <input type="checkbox"/> | <input type="checkbox"/> Areas that flood |

Other Considerations:

- | YES | NO | | | | |
|--|--|--------------------------------------|---------------------------------|--|-----------------------------------|
| <input type="checkbox"/> | <input type="checkbox"/> Children will use site when work crew departs | | | | |
| <input type="checkbox"/> | <input type="checkbox"/> Adults will be in work areas | | | | |
| <input type="checkbox"/> | <input type="checkbox"/> Security and theft concerns for materials left on site | | | | |
| <input type="checkbox"/> | <input type="checkbox"/> An Edgewater Landscaping sign is allowed on site | | | | |
| <input type="checkbox"/> | <input type="checkbox"/> Parking is available for equipment <table border="0" style="margin-left: 40px;"> <tr> <td><input type="checkbox"/> 16' trailer</td> <td><input type="checkbox"/> Bobcat</td> </tr> <tr> <td><input type="checkbox"/> Mid size dump truck</td> <td><input type="checkbox"/> Pick-ups</td> </tr> </table> | <input type="checkbox"/> 16' trailer | <input type="checkbox"/> Bobcat | <input type="checkbox"/> Mid size dump truck | <input type="checkbox"/> Pick-ups |
| <input type="checkbox"/> 16' trailer | <input type="checkbox"/> Bobcat | | | | |
| <input type="checkbox"/> Mid size dump truck | <input type="checkbox"/> Pick-ups | | | | |
| <input type="checkbox"/> | <input type="checkbox"/> Water is available on site | | | | |
| <input type="checkbox"/> | <input type="checkbox"/> Electrical is available on site | | | | |
| <input type="checkbox"/> | <input type="checkbox"/> Bathroom facilities are available on site | | | | |
| <input type="checkbox"/> | <input type="checkbox"/> Debris disposal available on site
(an additional charge of \$50 may be incurred for every load removed from the property) | | | | |
| <input type="checkbox"/> | <input type="checkbox"/> Other: | | | | |